

CM404RA-11R

11" LED SURFACE MOUNT
SURFACE MOUNT WITH TRIMLESS RIM

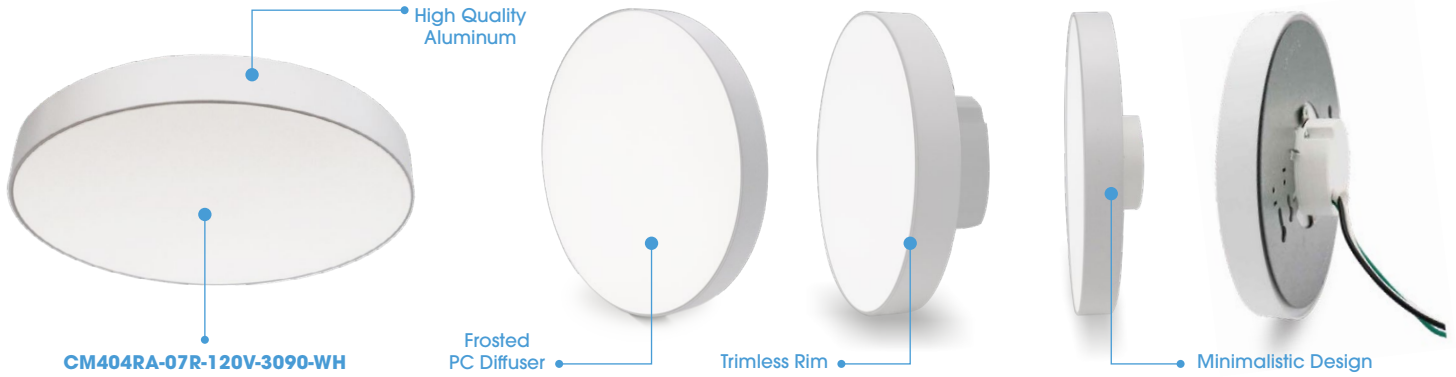

Fixture Type
Project
Notes



The LED Surface Mount with Trimless Rim series is designed for residential and commercial applications. With Minimalistic contemporary design, a trimless aluminum rim in white finish, and frosted polycarbonate creates a perfectly diffused bright white light. This Ultra Low Profile unit measures merely 3/4" deep, it is ADA Compliant for Wall Mounting, Triac dimming and installs easily in a standard junction box.



SPECIFICATIONS

INPUT VOLTAGE	120V AC
WATTAGE	20 W
LUMENS	1500 Lm
EFFICACY	75 Lm/W
CRI	90+
BEAM ANGLE	120°

DIMMING¹	TRIAC Dimming
ENVIRONMENT	Indoor - Dry & Wet
CERTIFICATIONS	cETLus, T24 Compliant
LUMEN MAINTENANCE	50,000 hours
WARRANTY²	5 years

¹ Effectively dim down to 10% / See other compatible dimmers on the next page
² See published warranty terms for detailed information

PERFORMANCE

COLOR TEMPERATURE	LUMEN	WATTAGE	EFFICACY	CRI
3000K	1500 Lm	20 W	75 Lm/W	90+
3500K	1500 Lm	20 W	75 Lm/W	90+

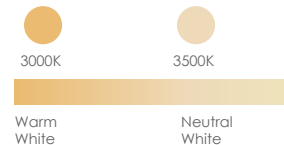

ORDERING INFO



MODEL CM404RA	-	SIZE 11R 11R - 11"	-	VOLTAGE 120V 120V - 120V AC	-	CCT / CRI 3090 - 3000K 90CRI 3590 - 3500K 90CRI	-	TRIM FINISH WH WH - White
-------------------------	---	---------------------------------	---	--	---	--	---	--

CM404RA-11R

11" LED SURFACE MOUNT
SURFACE MOUNT WITH TRIMLESS RIM



Fixture Type
Project
Notes

ACCESSORIES

Optional Accessories



PART NUMBER	CM404-MK
DESCRIPTION	Mount Kit includes: Mounting clip and E26 socket adapter



DIMENSIONAL DRAWINGS

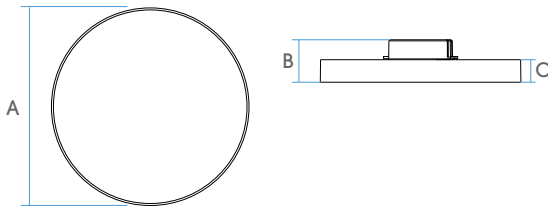

DIMENSIONS

A	11"	279 mm
B	1-5/8"	42 mm
C	3/4"	19 mm

INSTALLATION

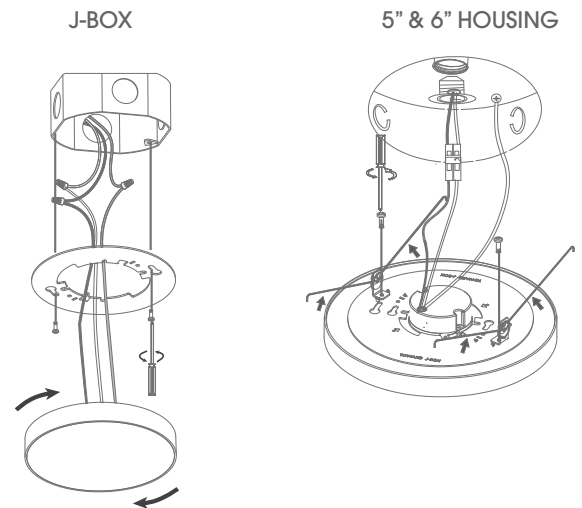

Each Box includes:

- Mounting bracket
- 1 J-box with Screws
- 3 Wire Nuts
- 1 Housing

COMPATIBLE DIMMERS

LEVITON	6681, 6672
LUTRON	PD-6WCL, DVCL-153P, CTCL-153P, MACL-153M, TGCL-153P